

THERMOSPAN® 200-20

INSULATED SECTIONAL STEEL DOORS



PREMIUM THERMAL EFFICIENCY AND LOW MAINTENANCE

Thermospan® Model 200-20 offers premium thermal efficiency combined with a heavy-duty 20-gauge flush exterior surface. Continuously foamed-in-place insulation and a non-conductive thermal break between the inner and outer skins, making it the ideal door for energy-conscious architects, engineers, contractors, and building owners.

The Thermospan® Series of doors are the only doors in the industry with patented, roll-formed integral struts on each section, making them the most rigid doors available.

» PREMIUM THERMAL QUALITIES
U-FACTOR  = 0.12
R-VALUE = 17.50

» STANDARD SIZES UP TO 24' 2" WIDE
AND 16' 1" HIGH

» RUGGED AND DURABLE

» SMOOTH, FLUSH EXTERIOR FINISH

» INTEGRAL STEEL STRUTS
FOR SUPERIOR STRENGTH

» 10K CYCLE SPRINGS STANDARD

THERMOSPAN® 200-20

STANDARD FEATURES OVERVIEW

THERMAL EFFICIENCY

U-FACTOR* 	0.12
R-VALUE**	17.50 (3.09 K m ² /W)
THERMAL BREAK	Thermoplastic adhesive with rubber seal
AIR INFILTRATION	0.17 cfm/ft ²

CONSTRUCTION

SECTION THICKNESS	2" (51 mm)
INTEGRAL STRUTS	Two 1-3/4" struts per section for strength and rigidity
MAX WIDTH	24'2" (4,902 mm)
MAX HEIGHT	16'1" (7,366 mm)
EXTERIOR STEEL	20-gauge
INTERIOR PER SECTION	Roll formed with two 1-3/4" integral struts sealed with polypropylene rib caps
STANDARD SPRINGS	10,000 cycles
INTERIOR COLOR	White

CODES AND ASTM STANDARD CLASS

STC (ASTM E 413)	Class 22
OITC (ASTM E 1332)	Class 19
ASTM E 84	Class A
UBC 17-5	Meets
ASTM D 1929	Flash ignition = 734° F Self ignition = 950° F

WARRANTY

TERMS	Ten (10) years against cracking, splitting, rust deterioration and delamination. One (1) year against defects in material and workmanship.
-------	---

OPTIONS

- Pass door
- Vision lites
- Aluminum full-view sections
- Chain hoist operation
- Motor operation
- Sensing edges
- TruChoice™ Color System
- Photo eyes
- High cycle spring (25k, 50k, 100k)
- 3" Track option
- Solid shafts
- Perimeter weatherseal
- Special track designs
- Mullions



Wayne Dalton participates in the DASMA Thermal Performance Verification Program. The program verifies the thermal performance of sectional doors. The lower the U-factor rating, the better the thermal performance.

 Symbol indicates verified U-factor rating in accordance with the DASMA Thermal Performance Verification Program.

*U-factor is independently tested and verified per ANSI/DASMA 105 using solid doors and specific product sizes.

**Wayne Dalton uses a calculated door section R-value for our insulated doors.

The Thermospan® 200-20 excels in energy efficiency and durability.

With a U-factor*  of .0.12 and an R-value** of 17.5, this door outperforms most conventional insulated steel doors.

MATERIALS AND CONSTRUCTION

The Thermospan® 200-20 has a patented manufacturing process with a polyurethane core that is continuously foamed-in-place between the outer and inner skins.

The outer skin of the hot-dipped galvanized, structural quality steel is factory-finished with baked-on corrosion-resistant primer and a white polyester finished coat. The inner skin is also hot-dipped galvanized steel, factory-finished with the same corrosion-resistant primer and polyester finish coat.

An innovative thermal break keeps the interior skin at room temperature, preventing condensation and frost and helping to resist corrosion.

Reinforcement plates are located at all hardware attachment locations. Commercial-grade hot-dipped galvanized hardware also contributes to the this door's long service life.



Thermospan® 200-20 is available with the TruChoice® Color System, Wayne Dalton's custom painting process that offers more than 6,000 colors. See dealer for details.

Actual colors may vary from brochure due to fluctuations in the printing process. Always request a color sample from your Dealer for accurate color matching.

Wind load options available



INSULATED SECTIONAL STEEL DOOR



LITE OPTIONS



Vision lites



Full-view lites

FINISH OPTIONS

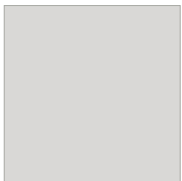

White Smooth
Flush Finish

DOOR CONSTRUCTION

Joint seal prevents air infiltration and saves energy.

Thermal break separates inner and outer skins so virtually no heat or cold is conducted through section. Pre-painted inner and outer skins for added corrosion resistance.

Solid polyurethane core provides maximum thermal efficiency and adds to quiet operation and strength.

Integral struts Two 1-³/₄" roll-formed struts per section increases rigidity and strength.

Two-inch nominal thickness.

Heavy-duty 20-gauge smooth, flush exterior skin gives the Thermospan 200-20 excellent strength qualities, ideal for large openings.

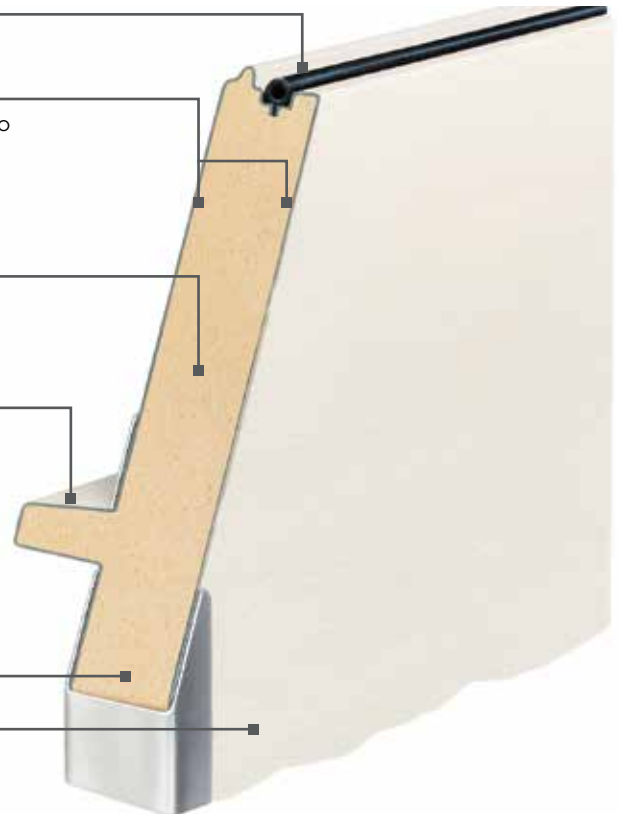

GENERAL OPERATING CLEARANCES

TYPE	HEADROOM		SIDEROOM		DEPTH INTO ROOM	CENTER LINE OF SPRINGS	
	2" TRACK	3" TRACK	2" TRACK	3" TRACK	2" AND 3" TRACK	2" TRACK	3" TRACK
Standard Lift Manual 12" R	13"-17"	NA	4.5"	5.5"	Opening Height +18"	Opening Height +12"	N/A
Standard Lift Manual 15" R	15"-20"	16"-21"				Opening Height +13"	Opening Height +14"
Standard Lift Motor Oper. 12" R	15"-20"	NA			Opening Height +66"	Opening Height +12"	N/A
Standard Lift Motor Oper. 15" R	15"-20"	18"-24"				Opening Height +13"	Opening Height +14"
High Lift Manual	High Lift +12"		24" One Side		Opening Height -Lift +30"	Opening Height +Lift +6.5"	Opening Height +Lift +7.5"
High Lift Motor Oper.							
Vertical Lift Manual	Door Height +20"		4.5"	5.5"	18"	Double Door Height +13"	
Vertical Lift Motor Oper.			24" One Side				
Low Headroom Manual	6"-15"	6"-15"	6"	9"	Opening Height +20" to -26"	N/A	
Low Headroom Motor Oper.	9"-17"	9"-17"			Opening Height +66"		

NOTES:

- For low headroom, springs must be rear mount to achieve minimum headroom listed. Front mount torsion headroom depends on drum size, and varies over the range listed. See approval drawing.
- Side-room of 8" required, one side, for doors with chain hoist.
- Headroom depends on drum size, and varies over the range listed. See approval drawing.

PANEL/SECTION SELECTION GUIDE

DOOR WIDTH	NUMBER OF PANELS	NUMBER OF LITES	DOOR HEIGHT	NUMBER OF SECTIONS
Up to 9'2"	2	2	Up to 8'1"	4
9'3" to 12'2"	3	3	8'-2" to 10'1"	5
12'3" to 16'2"	4	4	10'2" to 12'1"	6
16'3" to 19'2"	5	6	12'2" to 14'1"	7
19'3" to 24'2"	6	7	14'2" to 16'1"	8
24'3" to 28'2"	Call Factory		16'2" and Up	Call Factory

TRACK SELECTION GUIDE

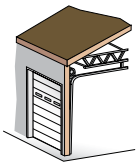

STANDARD LIFT



HIGH LIFT
break-away is standard, straight incline is available

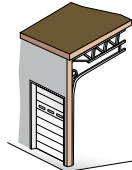

ROOF PITCH
standard or high lift

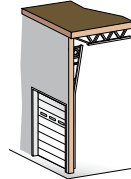

VERTICAL LIFT
break-away is standard, straight incline is available

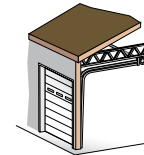

LOW HEADROOM
rear mount torsion

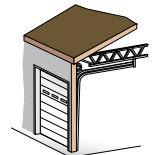

LOW HEADROOM
front mount torsion



Architect Resource Center

Visit wayne-dalton.com/architect-resource-center to find our Architect Resource Center. In this tool, you will quickly find all of the specifications, drawings and documents you need to complete your project.

Wayne Dalton
COMMERCIAL DOORS

DISTRIBUTED BY:

2501 S. State Hwy. 121 Bus., Ste 200
Lewisville, TX 75067

wayne-dalton.com

